

colophon

projects  
collaboration  
photography

visualisations  
drawings  
grafic design  
print  
translation  
production

jan doms, dr. pamela doms, lef stadsdynamica  
olga doreva  
ernest potters, martin stoop, dorien bedaux, jan doms,  
olga doreva, pamela doms, marie-josé vromans  
ir. philip van boxtel  
jan doms, ir. philip van boxtel, piet leeflang  
jac de kok  
star foto, bladel  
dr. jill bradley, language services  
lef stadsdynamica

for the occasion  
mallorca translocal meating 2013  
can gelabert, sant marc, pilar i joan miró a mallorca foundation



jan doms and olga doreva at work in central  
mineral bath, sofia 2011



lef studio, tilburg

lef operates in various countries. in sofia, jan doms collaborated in three projects with the architect olga doreva. in mallorca they col-laborate again creating a glass structure.

- 01 heaven on earth, sofia
- 02 regained history, sofia
- 03 pancharevo balloon party, sofia
- 04 frost, roermond
- 05 aircraft I and II, eindhoven, maastricht
- 06 production tower maxima I, eindhoven
- 07 bill board mobile, eindhoven



pamela doms and jan doms at vernissage  
biennial, roermond 2012



lef office, tilburg

in 2001 jan doms founded lef stadsdynamica, office for spatial design and research. in 2011 dr. pamela doms became partner in lef. the company is based on the concept of a network organization.

- 08 ballad of the rising sun, monster westland
- 09 serdica triangle, roermond
- 10 transportable bench and cabinet, goirle
- 11 bill board and exhibition tables, hilvarenbeek
- 12 serdica triangles, palma de mallorca
- 13 wagon, tilburg
- 14 exhibition pavilion oude warande, tilburg



heaven on earth - central mineral bath, sofia bulgaria 2011 design: jan doms | glass construction: jan doms and olga doreva  
principal: water tower art fest sofia 2011



heaven on earth is an elongated composition made out of connected rectangular glass blades adapted to the architecture of central mineral bath. mathematical precision is the basis of this transparent organic space.



façade central mineral bath sofia

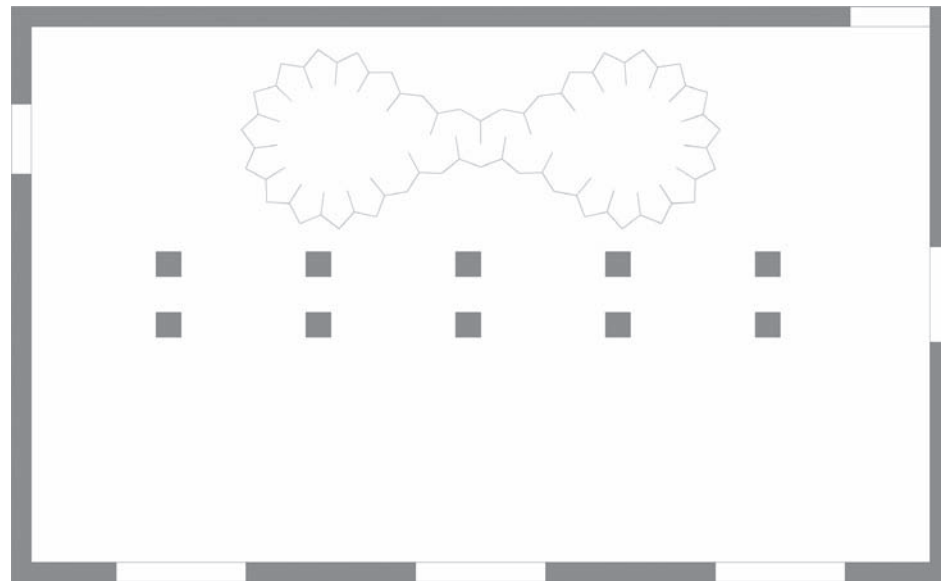

plan space mineral bath sofia | diagram: ir. philip van boxtel

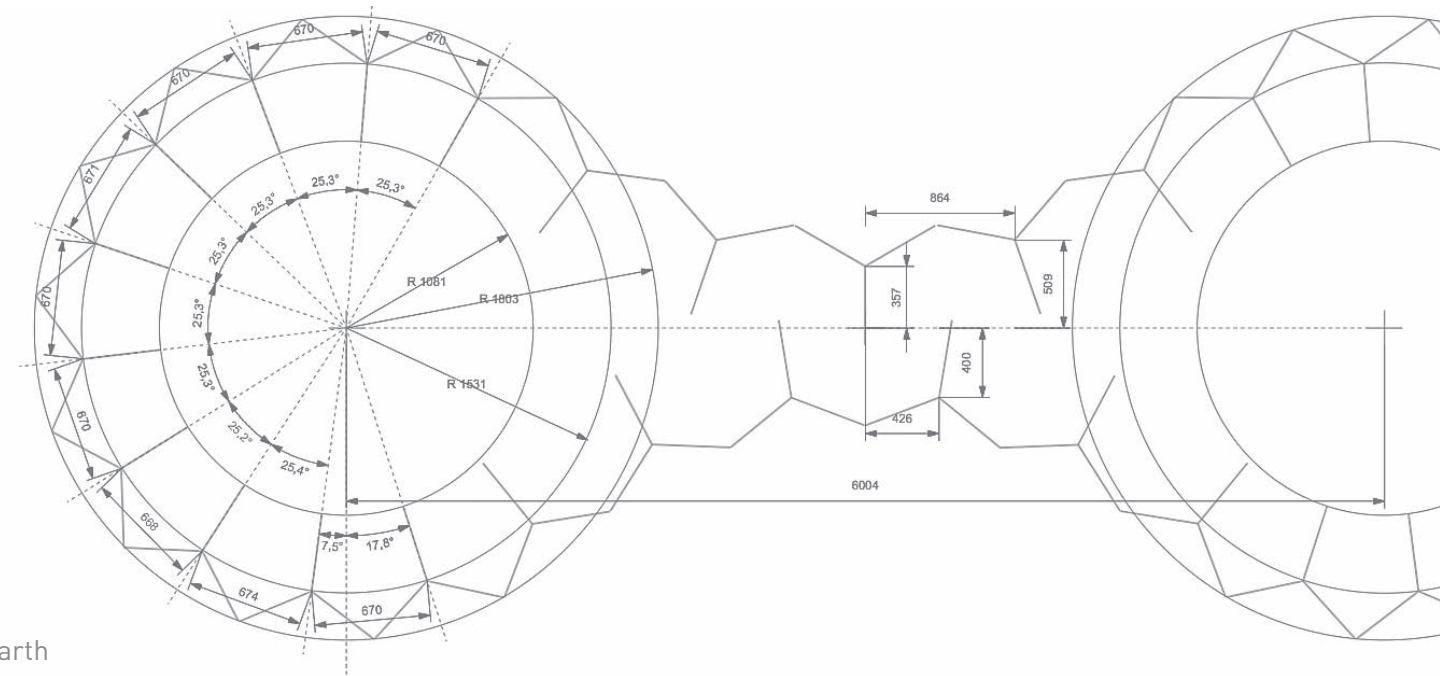

diagram heaven on earth





regained history - basement roca building, sofia bulgaria 2012 design: jan doms | glass construction: jan doms and olga doreva  
principal: water tower art fest sofia 2012

the triangular roman fortification in glass is created as a kind of 'curtain' made out of glass, floating above the roman remains (wall and tower) in the basement of the roca building in central sofia. the roca basement is an extension of the national history museum sofia.



map remains old roman city of serdica



roca building central sofia



preliminary design floating glass structure



work in progress





pancharevo balloon party - sredets national rowing base on the shore of lake pancharevo, sofia bulgaria 2012 design: jan doms  
| glass construction and performance: jan doms and olga doreva | principal: water tower art fest sofia 2012

the performance pancharevo balloon party took place in the deserted concrete architectural structure that was used in the early days to show the results of the boat-races over the rowing course.



sredets national rowing base lake pancharevo 1968



architectural structure to show the results of the boat-races





frost - stedelijk museum roermond, the netherlands 1988 to the present: tour along theatres and art galleries | construction and performance: jan doms | glass handling: janhein van stiphout | principal: de maatschap international



frost is a dynamic large scaled glass sculpture that one can animate by walking on the inner glass surface. at the beginning the image represents the icy slopes of the high mountains. at the end of the long walk the sculpture turns in into a cone of glass (shrine). This project is inspired by the novel of the same name written by thomas bernhardt (austria).

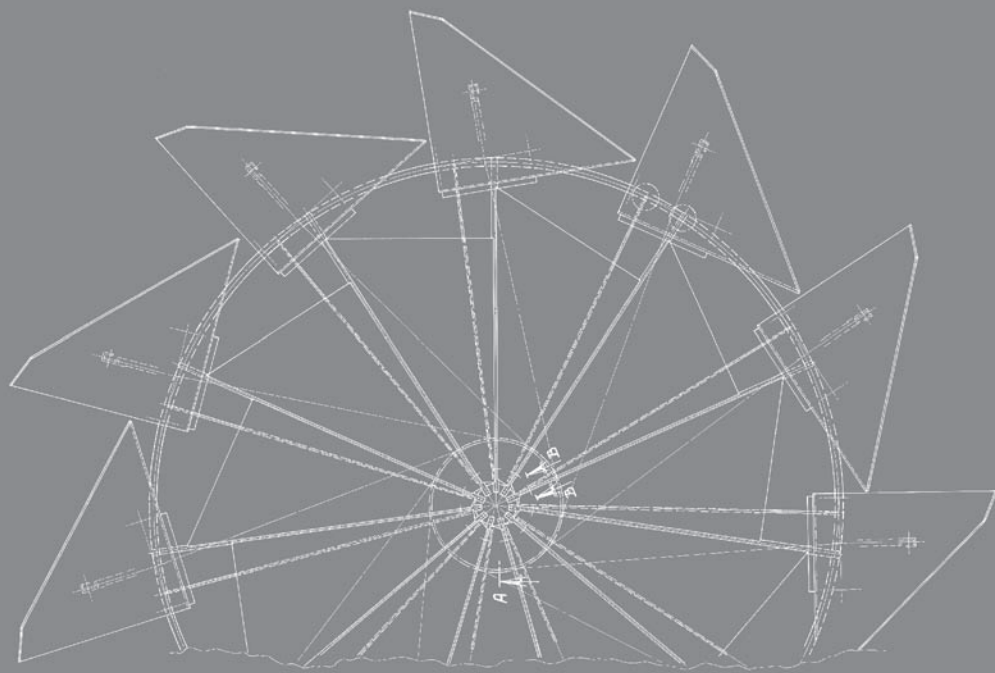

drawing: piet leeflang



detail



detail





aircraft I - basement engine room strijp s, eindhoven the netherlands 2011 | aircraft II - basement high culture gallery, maastricht the netherlands 2012 design and construction: jan doms | principal: glass is more, dutch design week



aircraft I and II are constructed with elements made from cut steel and glass circles. stealth fighters and drones inspired the creation of a number of dynamic hovering sculptures which express the idea of flying in sinister bad air space.

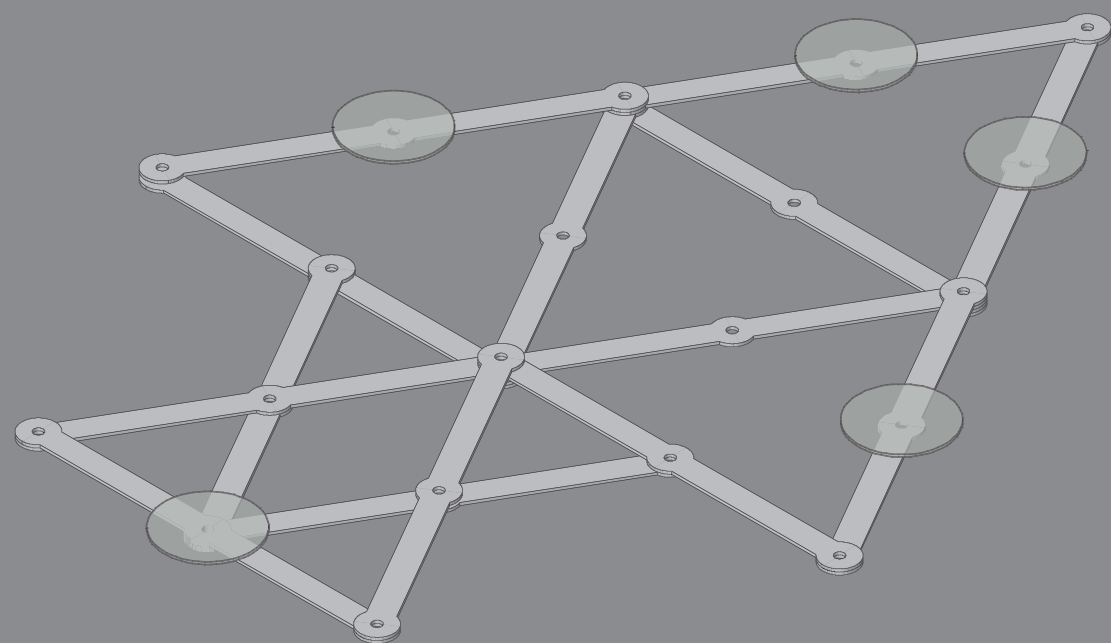

isometry aircraft I: ir. philip van boxtel



aircraft II - basement high culture gallery



animation aircraft II





production tower maxima | *height 52 metre* - beatrixkade, eindhoven the netherlands 2009 design: jan doms | construction: ask romein, cockerits, m-tech | principal: saint-gobain weber beamix



the new production tower for dry mortar maxima | fits in with the surroundings efficiently and became a landmark that fires the imagination. the initial idea was to add an element of femininity to this unmistakably masculine world. because of its elegance the workers spontaneously named the tower 'maxima' after the new queen of the netherlands.



source of inspiration | tree tokio

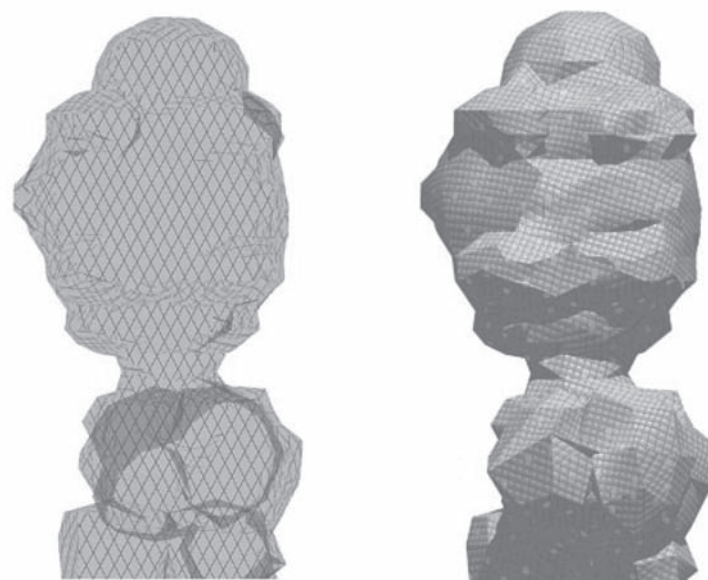

preminilary design step by step | visualisation ir. philip van boxtel

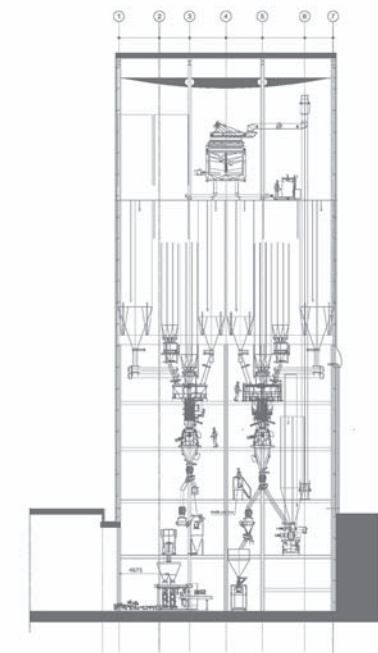
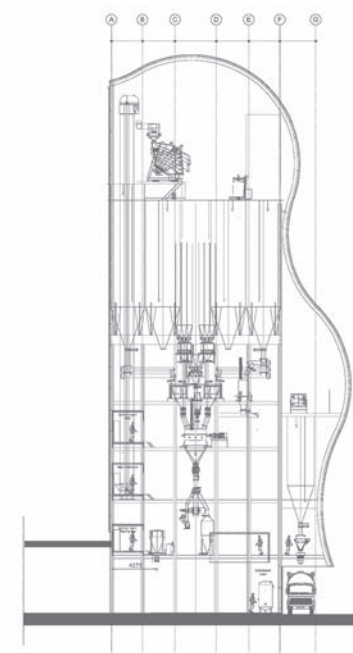

manufacturing process dry mortar



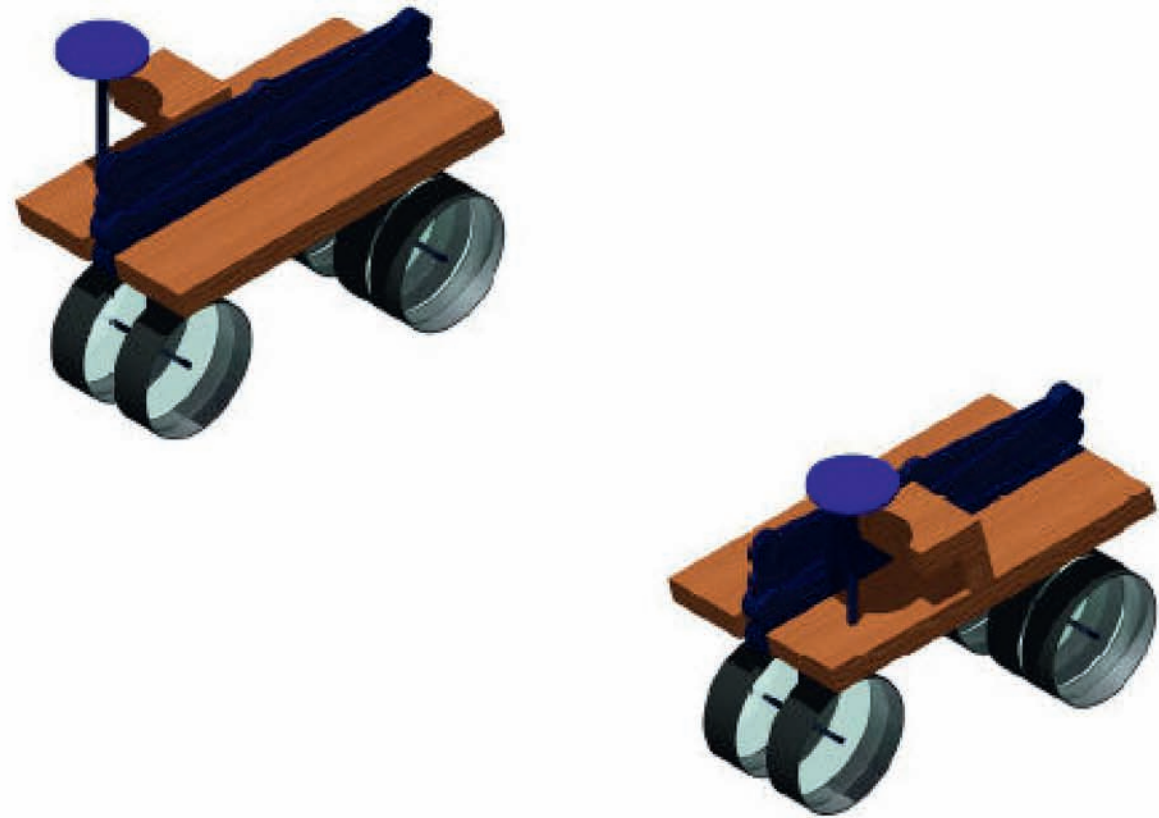

bill board mobile - vertigo building, eindhoven the netherlands 2009 design and manufacture: jan doms | glass application: 360 glass, principal: eindhoven university of technology, department of architecture, building and planning

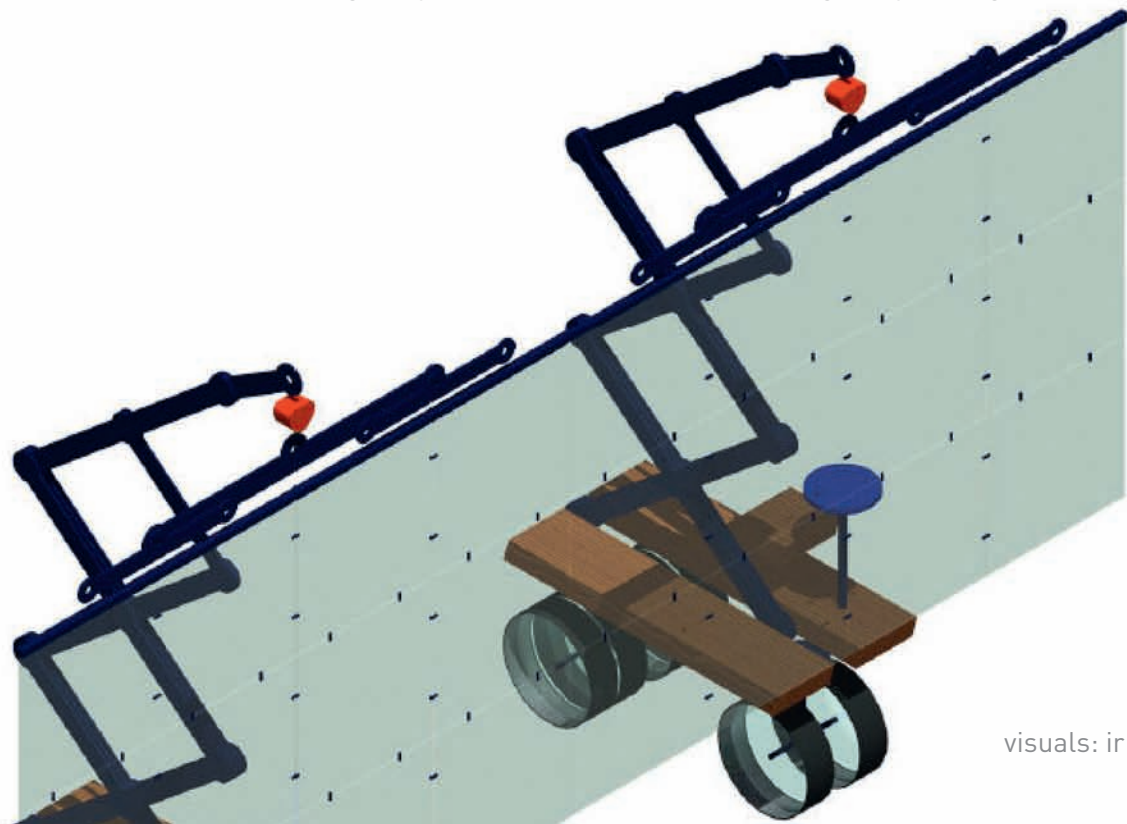

visuals: ir philip van boxtel



bill board mobile is created as a new icon for the students of the department of architecture, building and planning. the programme organization casa makes use of the bbm to announce exhibitions, lectures and special projects according to this department.

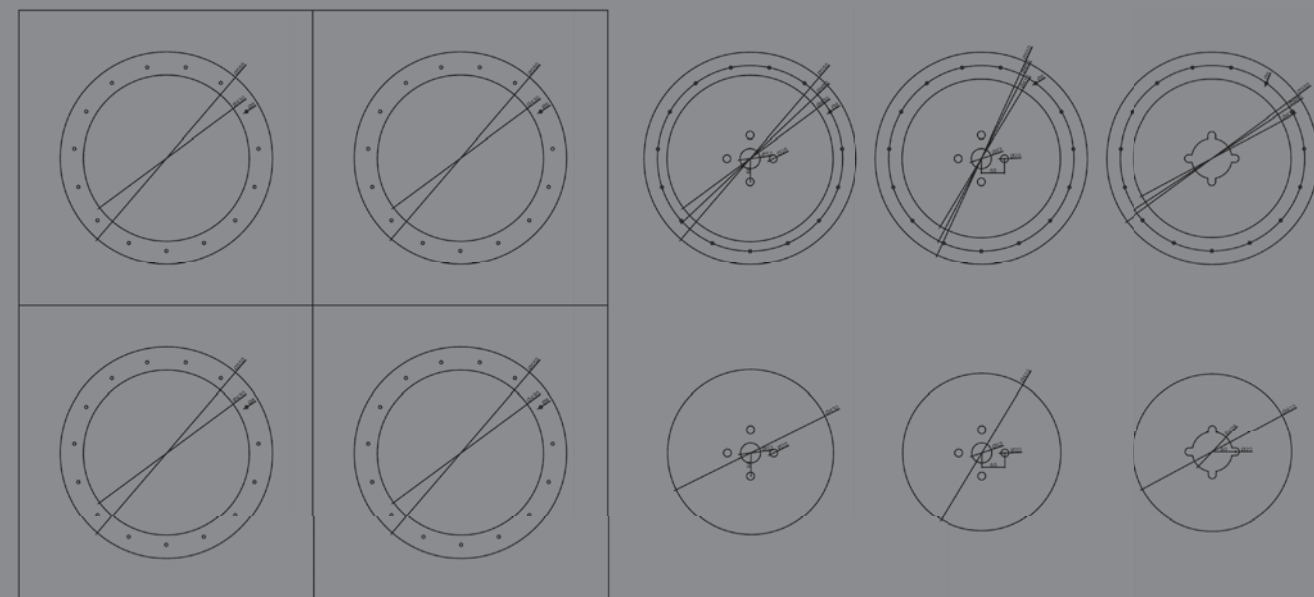

draft wheels: stef hagemeijer 360 glass





ballad of the rising sun - greenhouse zwin brothers, monster westland the netherlands 2011 script, stage design and direction: jan doms | on stage: yuka kawabe, westlands mannenkoor, paul van kemenade quintet, serigne gueye, ries doms, wout kemkens, strijbos & van rijswijk, wiersma & smeets, nol van trier | principal: biennial kijkin the Hague 2011

ballad of the rising sun is a dynamic fusion of glass art, music, electronics, laser and video. jan doms had the beautiful voice of the Japanese singer Yuka Kawabe in mind when he wrote the ballad 10 songs. it is based on the compositions of the Dutch composer Paul van Kemenade and its narrative element is inspired by the daily life in the city of glass Westland.



part 5 performance



part 4 performance, yuka kawabe singing



part 6 performance, ries doms percussion with glass circles





serdica triangle - garden cloisters karthuzian monastery roermond, the netherlands 2012 design and production: jan doms | principal: mariska dirx gallery and young culture gallery *biennial roermond 2012*



serdica triangle is a glass structure that derives from the fortification which is part of the roman remains below ground level in sofia. its triangular shape is extraordinary for roman architecture and city planning. trinity is a vital symbol in the catholic tradition.







transportable bench and cabinet - living graphic designer, goirle the netherlands 2013 design and manufacture: jan doms | principal: jac de kok



the transportable bench is built with elements made from cut steel that hold the top and two heavy duty castors in position. the table top is made from robust varnished multiplex. in combination with the special matching cabinet it defines the working and living space and forms a visual link with the garden.

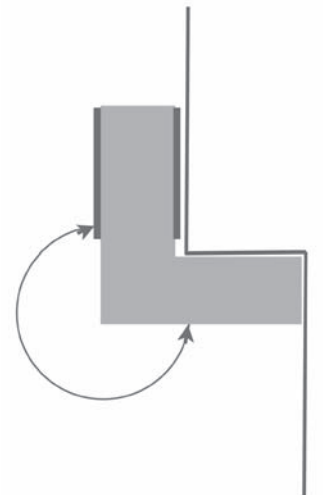
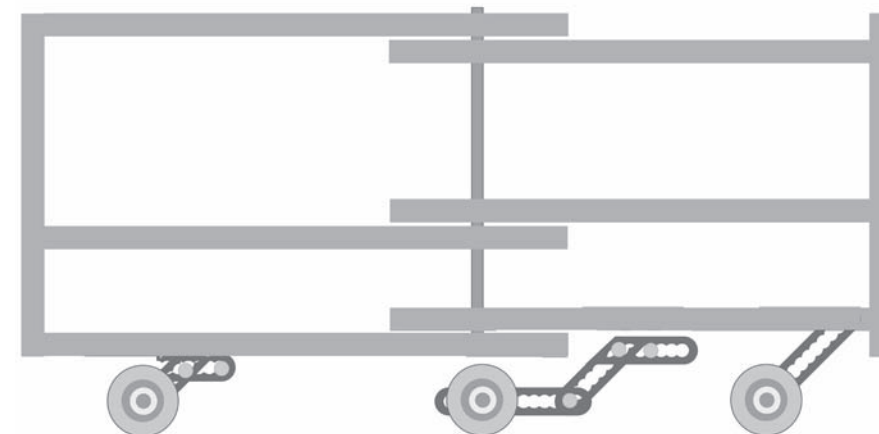
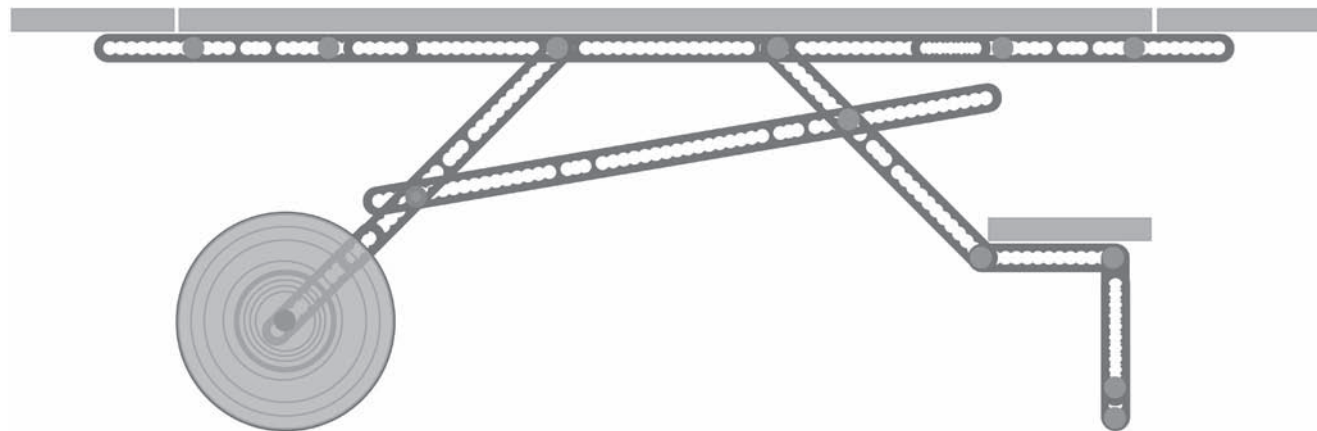





bill board and tables exhibition 30 years graphic design jac de kok - restored photo studio, hilvarenbeek the netherlands 2005  
design and manufacture: jan doms | principal: hilvaria studio's foundation



billboard and tables are designed for the exhibition tour 30 years graphic design jac de kok. architect jacq. de brouwer spontaneously named the tables dancers. after the tour jan doms designed a new top made of hardened glass in order that the tables could be used in office or gallery.

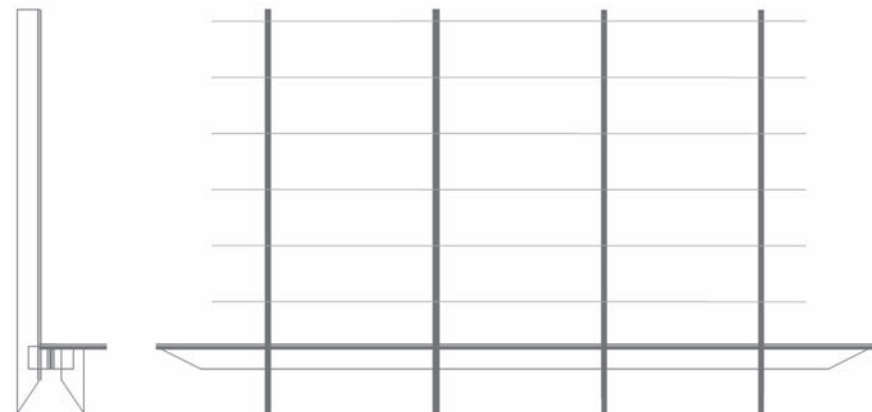

draft bill board table

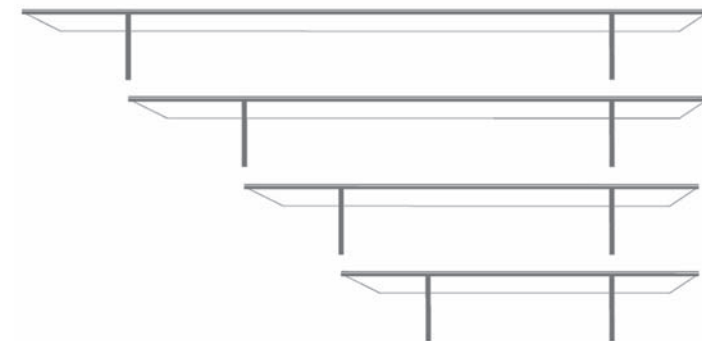

draft four exhibition tables

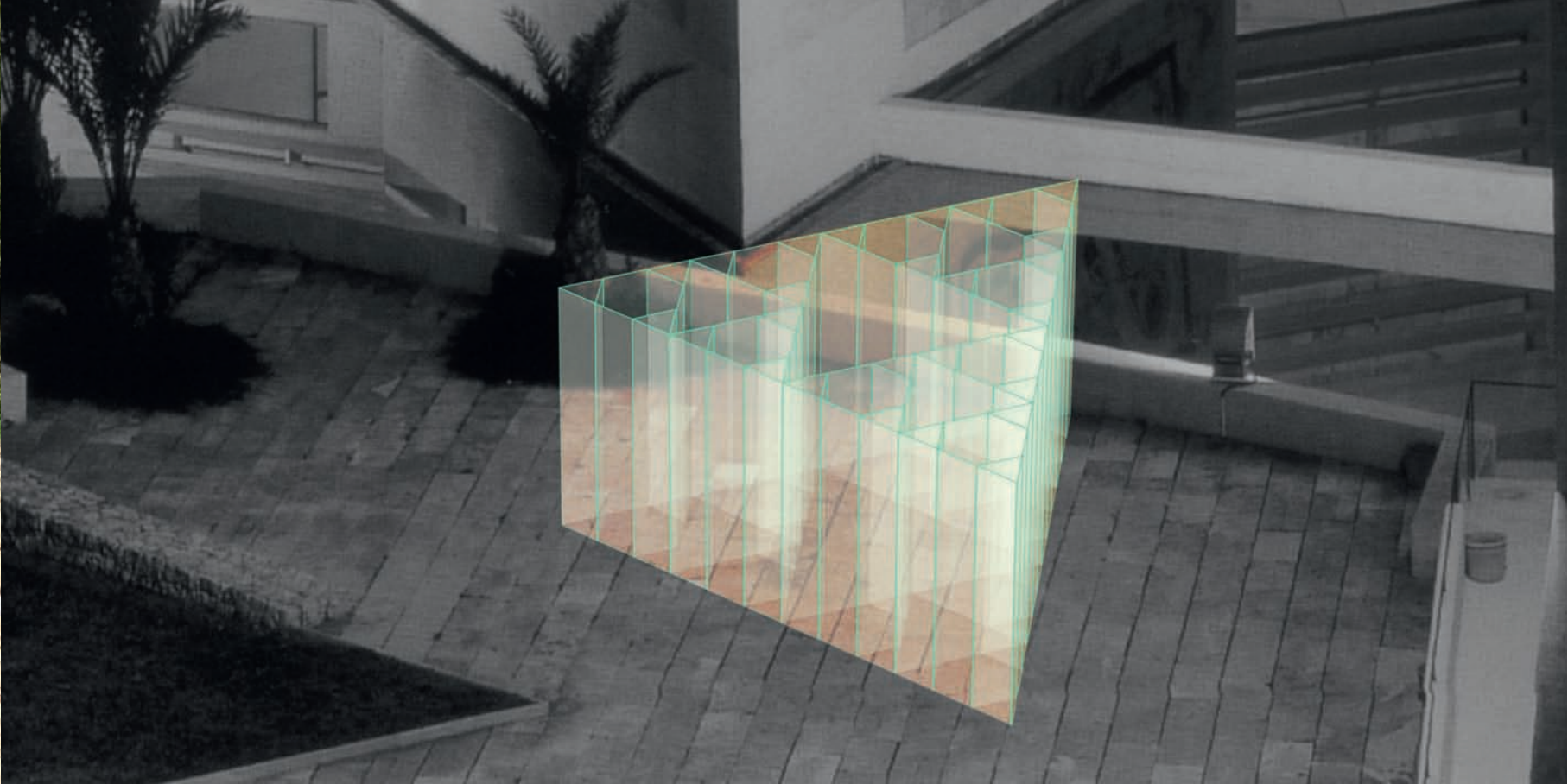

table in luycks gallery as part of exhibition sofia city bar 2012





serdica triangles - sculpture terrace and palm tree terrace moneo building area, pilar i joan miró a mallorca foundation, mallorca  
spain 2013 design: jan doms | visualisation: ir. philip van boxtel | principal: sant marc and joan miró a mallorca foundation



the initial inspiration for the **serdica triangles** were the triangular fortifications that are part of the roman remains in sofia. in this case the triangles are adapted to the idiom of the architect of the miró museum, rafael moneo.

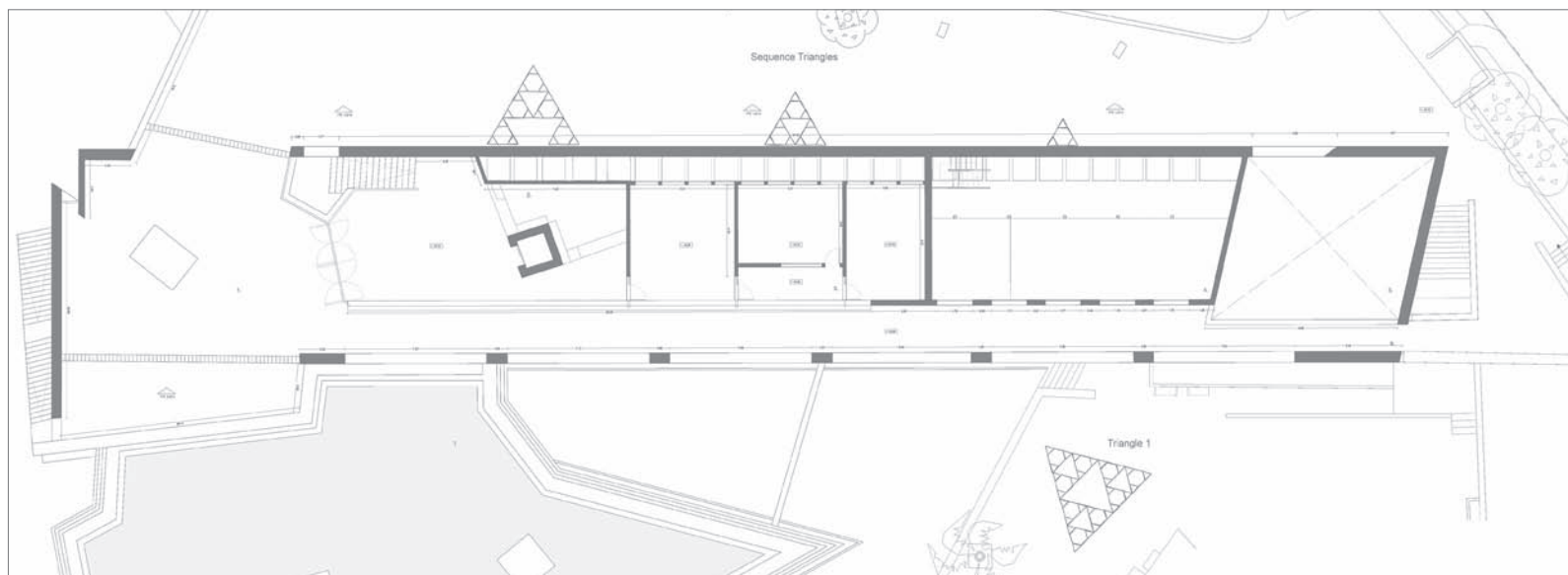

plan area and position of triangles

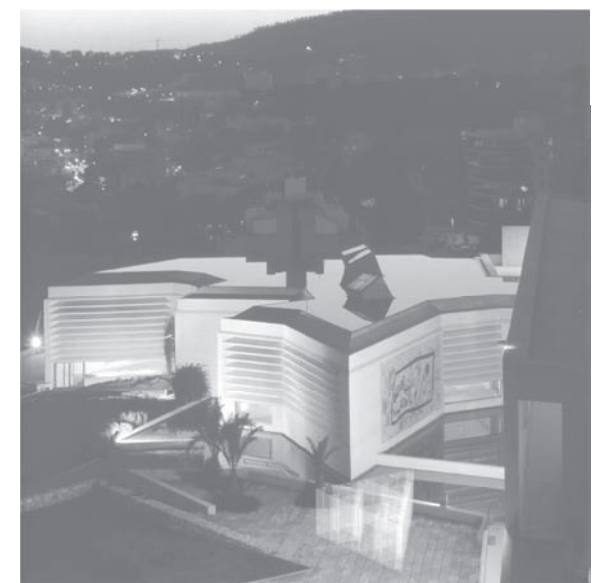

overview area



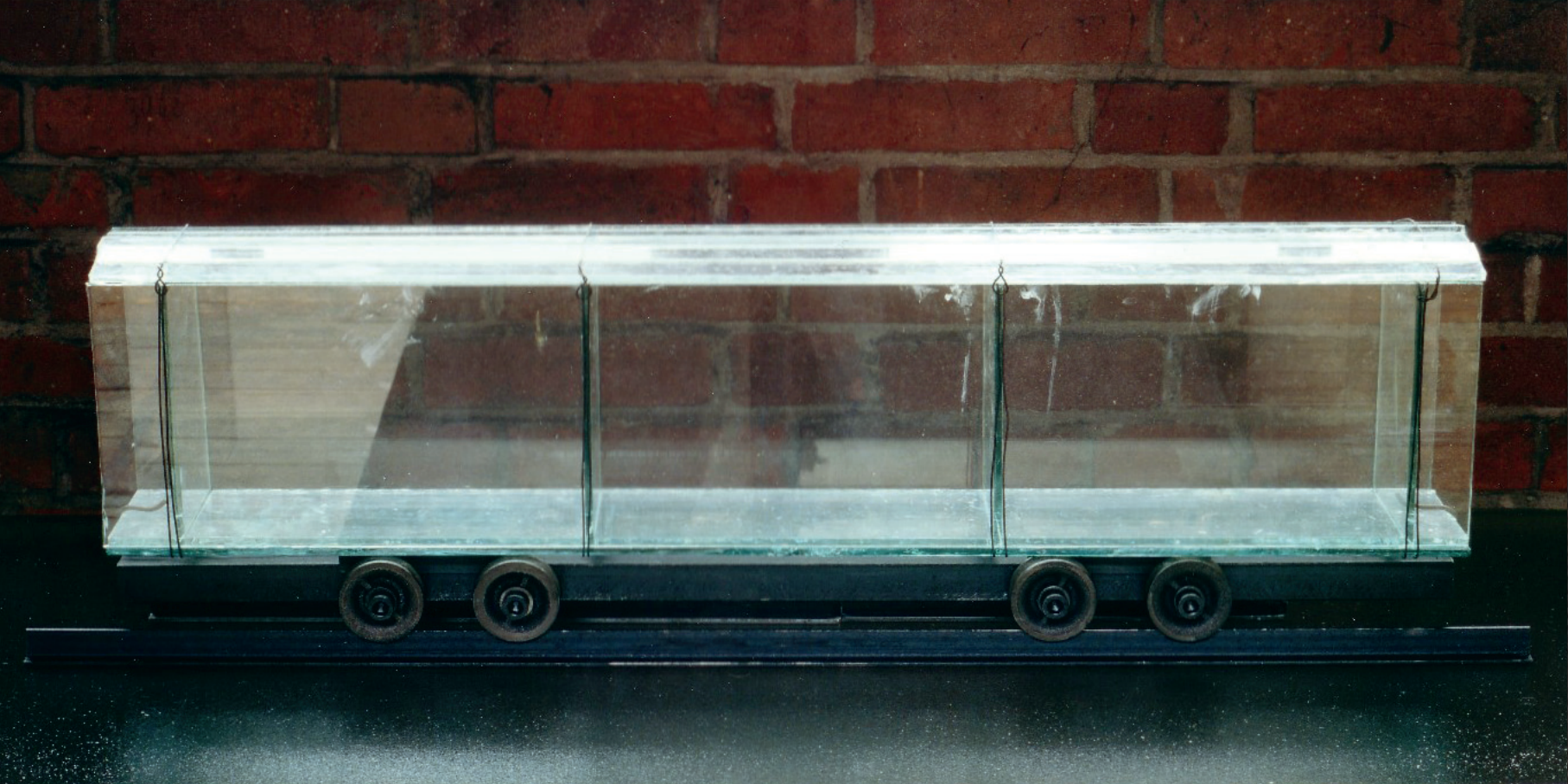

wagon - luycks gallery, tilburg the netherlands 2000 design and manufacture: jan doms | glass handling: janhein van stiphout and stef hagemeyer | principal: kathareze gallery



wagon is designed as an extension of the art gallery and fits very precisely into the elongated courtyard.

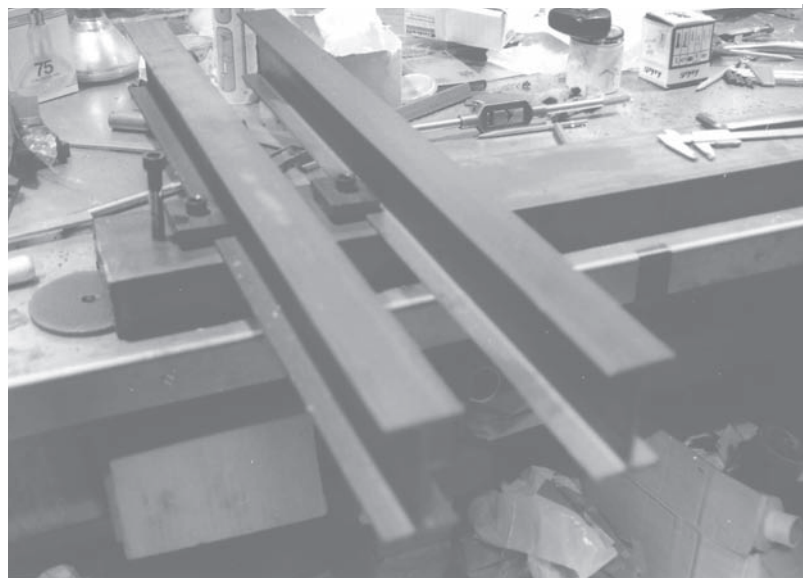

work in progress

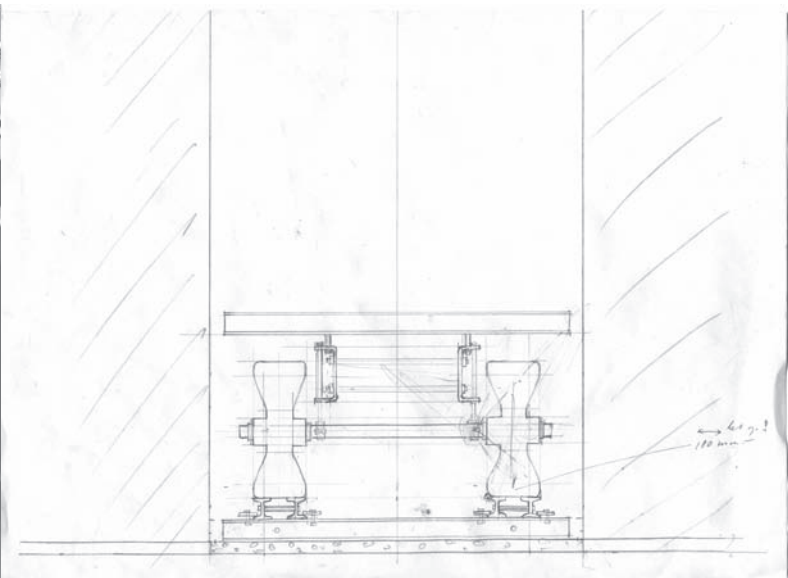

draft undercarriage

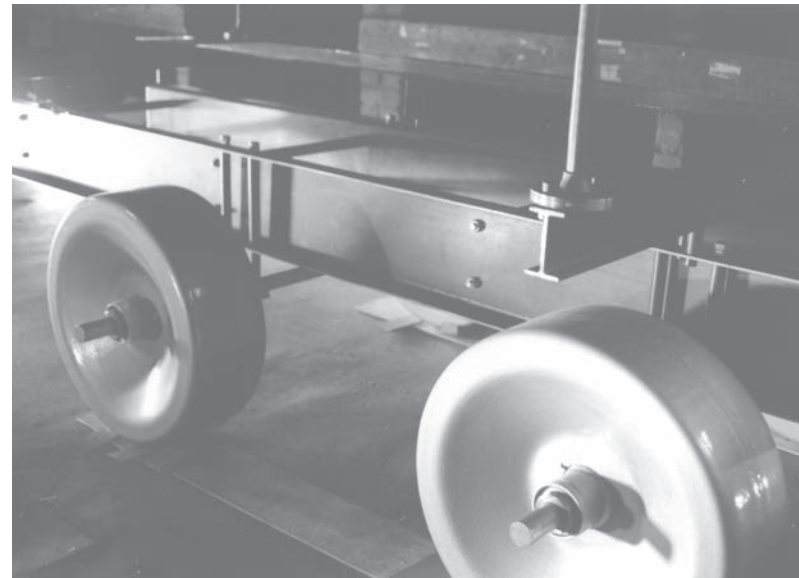

work in progress





exhibition pavilion - restored 18th century domain oude warande, tilburg the netherlands 2006 design and construction: jan doms | spatial research in 2012: dr. pamela doms | principal pavilion: maatschap mixt | principal research program: tilburg local authority



the exhibition pavilion oude warande is designed for the park holiday. jan doms made use of parts of an historical steel construction originating from the city of leuven, belgium. the exhibition of the history and restoration of oude warande is printed on hardened glass panels. tilburg local authority commissioned dr. pamela doms to carry out spatial research in the area of oude warande.

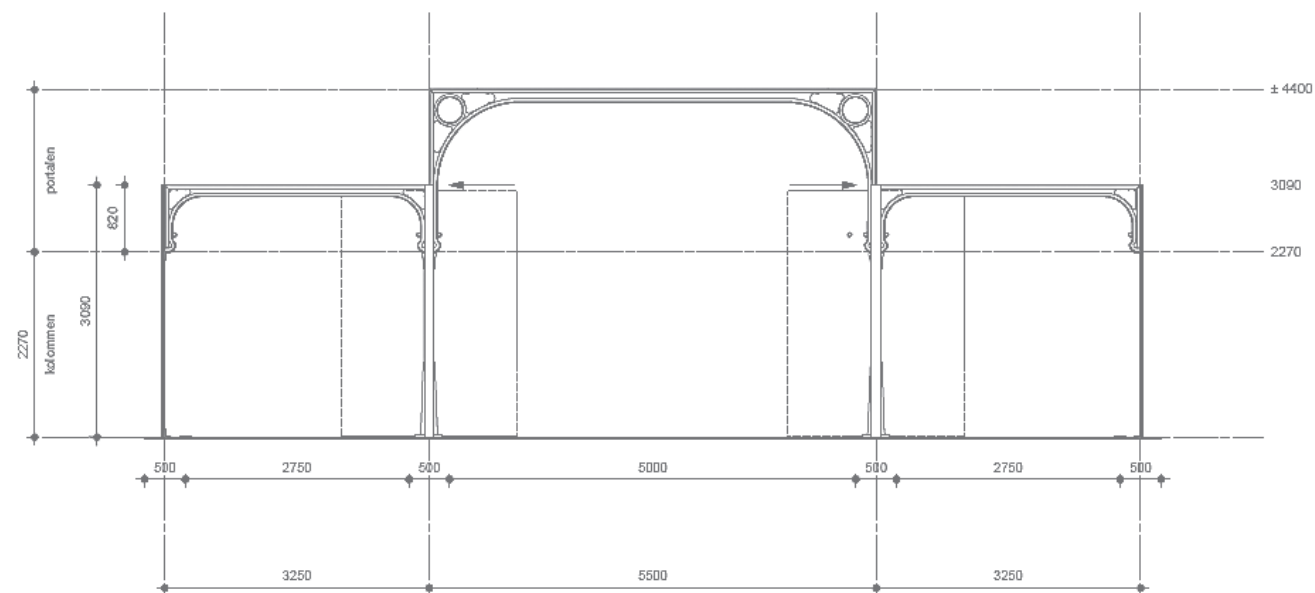

drawing: ir. philip van boxtel

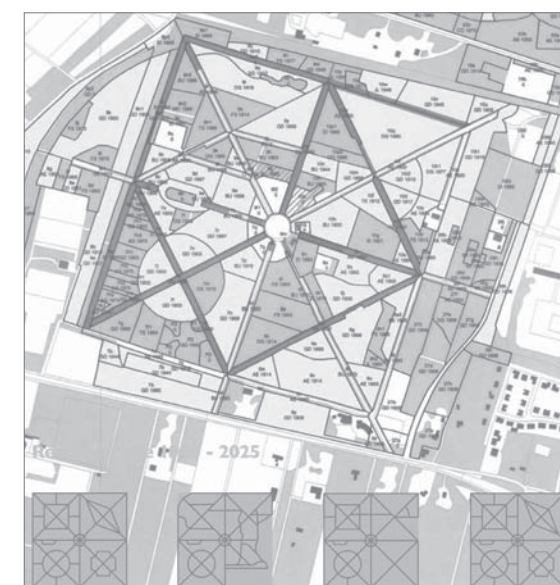

map oude warande



one of the characteristic lanes oude warande